

## Changing TerraCyclic is as easy as 1, 2, 3!

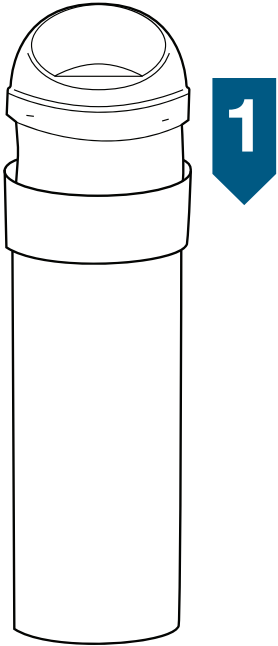

- 1.** Place a new cartridge refill in the empty cylinder ensuring that the bag is fully extended and that the modesty flap is properly attached.

- 2.** When the cartridge is full, simply remove the entire cartridge (lid & bag) from the cylinder. All unsanitary items will be contained fully within the bag.

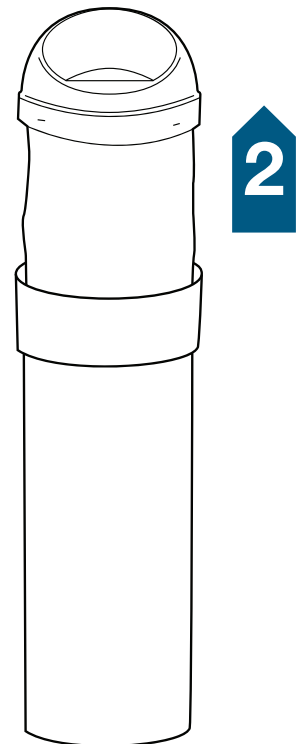

- 3.** Dispose of the entire cartridge in a general waste bin. The cartridge is biodegradable and can be discarded safely with normal refuse.

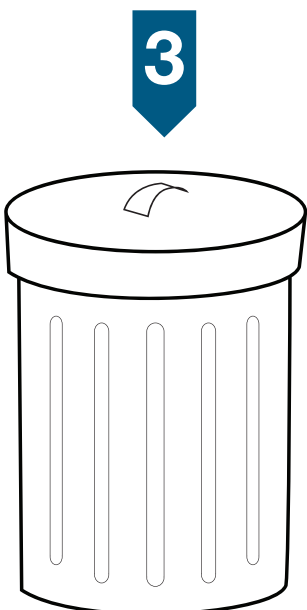

## Attaching the Modesty Flap to the Bio Bin

- 1.** Detach the tab joining the Modesty Flap and the Bio Bin Lid. Discard the tab.

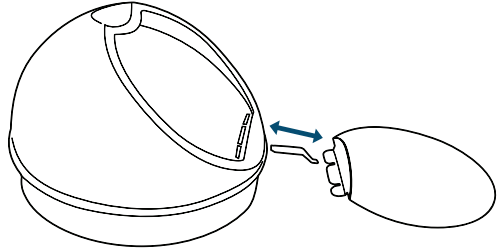

- 2.** Insert the 3 tabs on the Modesty Flap into the 3 holes at the base of the Lid opening. Ensure that the curved lever is facing down.

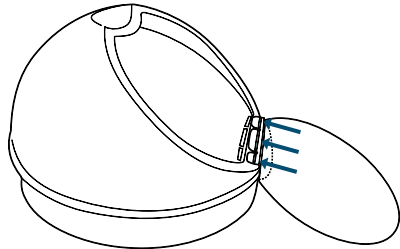

- 3.** Push the Modesty Flap down until it has locked into the lid. Swing the Modesty Flap back toward the Lid.

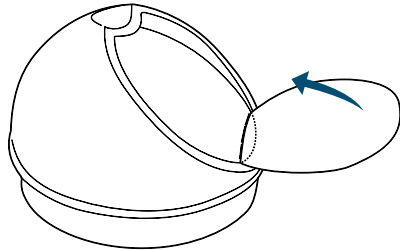

- 4.** The Lid and Refill Cartridge are now ready to be placed in the empty Cylinder.

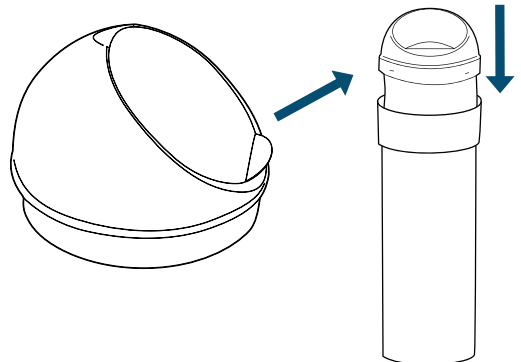



# TerraCyclic™ Installation Instruction Sheet



## Base Unit Assembly

Regular

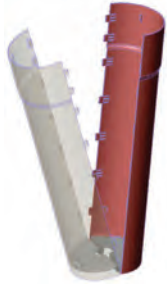

1. Insert base disc into each half with flush (smooth) side facing upwards.
2. Clip two halves together

Large



1. Insert large base disc into each half.
2. Clip two halves together

Small

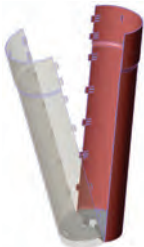

1. Clip two halves together
2. Push base disc into place, once halves assembled

### Step One



Screw or double sided tape bottom (A) bracket to wall approx. 100mm or 4" from floor. (See overleaf for bracket instructions)

### Step Two



Fit base into bottom bracket and screw top of unit (marked X) to wall using wall plugs as required, or optional bracket, for fixing see overleaf.

### Step Three

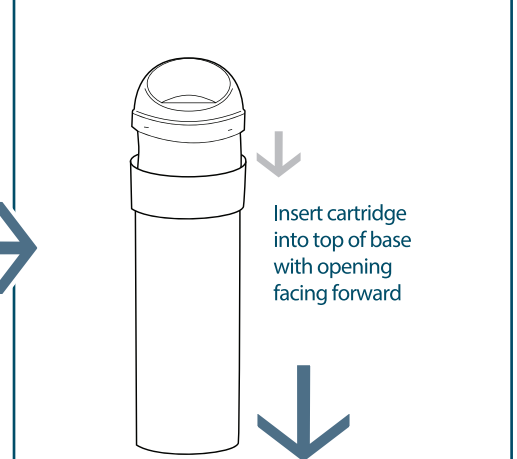

Insert cartridge into top of base with opening facing forward

### Step Five

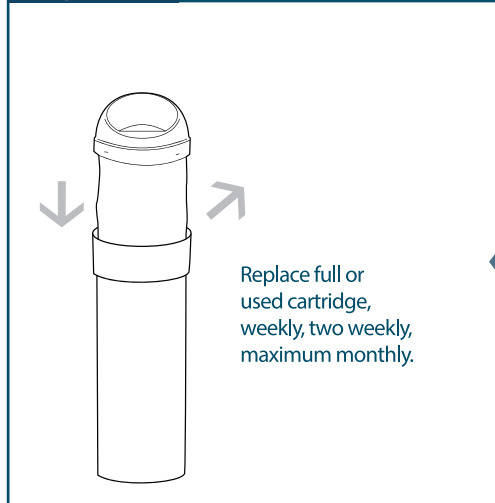

Replace full or used cartridge, weekly, two weekly, maximum monthly.

### Step Four

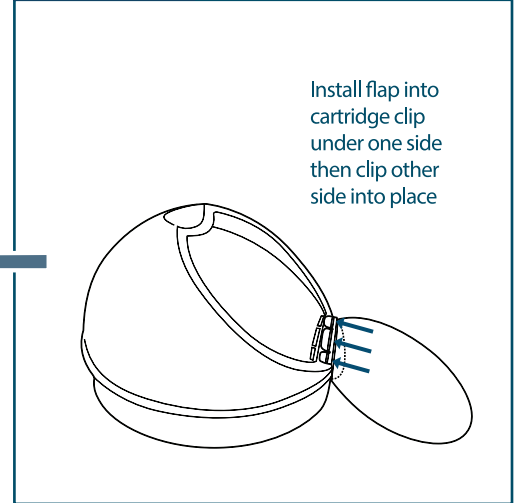

Install flap into cartridge clip under one side then clip other side into place



# Wall Mounting Options

- OPTION ONE: Directly screw into wall
- OPTION TWO: Double sided tape to wall

**FIXINGS NOT SUPPLIED**

- 4x self tapping screws
- 4x wall plugs
- Double sided foam tape (optional if required)

## A. Compulsory Bottom Bracket

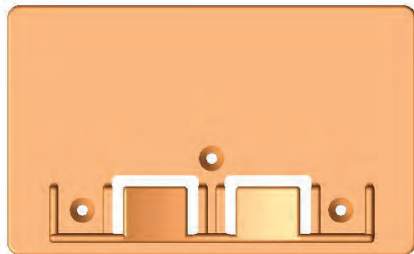

Screw or double sided foam tape to wall  
- approx. 100mm or 4" from floor.

## B. Optional Top Brackets

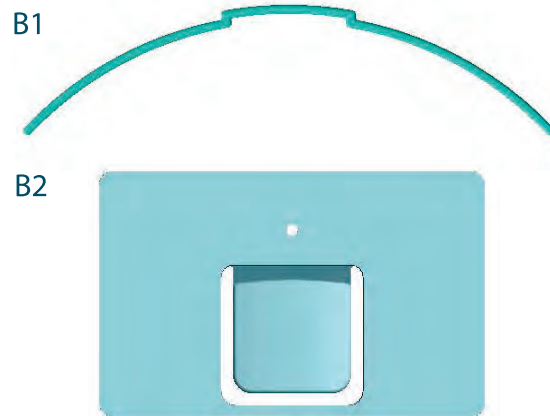

N.B. Only required when screw fixing in step two is not desirable.

Double side tape B1 to top of base. Fit B2 into B1, double side foam tape back to B2 and fix against wall.



TerraCyclic™

INSTALLATION  
INSTRUCTIONS